

# 3400 INDUSTRIAL LANE

## OFFICE & INDUSTRIAL SPACE AVAILABLE IN BROOMFIELD

**CONTACT:**

[PATRICK WEEKS](#)

OR [LYNDA GIBBONS](#)

(303) 442-1040

[WWW.GIBBONSWHITE.COM](http://WWW.GIBBONSWHITE.COM)

**SPACE AVAILABLE:** 1,200 – 8,700 SF

**LEASE RATE:** ~~\$3.50~~ NNN (\$3.14 + UTILITIES)  
**\$1.00 NNN YEAR ONE**

**AVAILABLE:** IMMEDIATELY



The information above has been obtained from sources believed reliable. While we do not doubt its accuracy, we have not verified it and make no guarantee, warranty, or representation about it.

**\$1.00 NNN LEASE RATE SPECIAL  
FOR ALL NEW LEASES!**

- HIGH VISIBILITY ON HIGHWAY 36 JUST NORTH OF INTERLOCKEN
- NEWER EXTERIOR PAINT AND LOBBY FINISHES
- FIRE SPRINKLERS



2305 CANYON BLVD, SUITE 200  
BOULDER, CO 80302

# 3400 INDUSTRIAL LANE

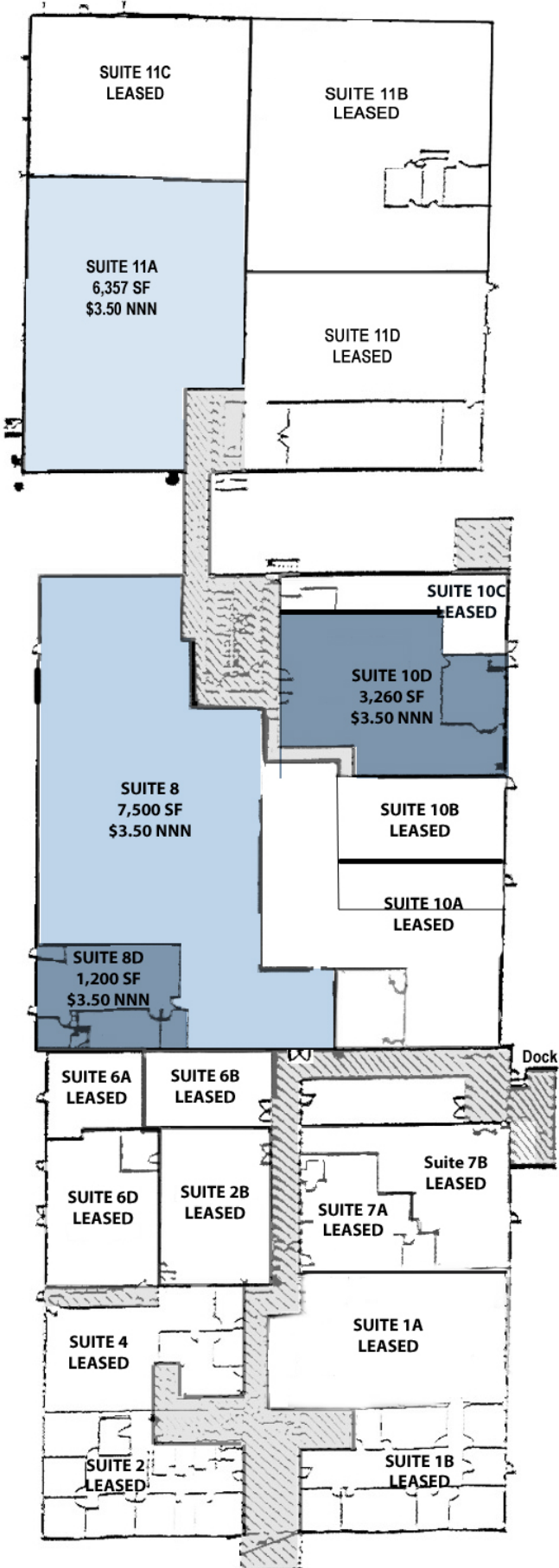

**ABUNDANT  
SIGNAGE  
OPPORTUNITIES  
FRONTING  
HIGHWAY 36!!!**

